

LINE NO.	LOCATION	DESCRIPTION	OPERATOR	EUB LIC.#	DWG No.
1X	N.E. 1/4 Sec.14	20.00 ACCESS ROAD	OIL CO.	-	N/A
2X	N.W. 1/4 Sec.14	P.L.R.W PLAN 042 4070 - BURIED PIPE	CANOL	37032	06-0561-2X
3X	N.W. 1/4 Sec.14	DRAINAGE CROSSING (±1m WIDE)	-	-	06-0561-3X
4X	N.W. 1/4 Sec.14	2 WIRE OVERHEAD POWERLINE	FORTISALBERTA	-	06-0561-4X
5X	N.E. 1/4 Sec.15	GOVERNMENT ROAD ALLOWANCE	STARLAND COUNTY	-	06-0561-5X
6X	N.E. 1/4 Sec.15	BURIED TELUS CABLE	-	-	06-0561-6X
7X	N.E. 1/4 Sec.15	20.00 ACCESS ROAD	OIL CO.	-	N/A
8X	S.E. 1/4 Sec.15	P.L.R.W PLAN 042 2878 - BURIED PIPE	BRCL	36362	06-0561-8X
9X	N.E. 1/4 Sec.15	UNREGISTERED 15.00 P.L.R.W PLAN	OIL CO.	-	N/A
10	N.W. 1/4 Sec.15	20.00 ACCESS ROAD	OIL CO.	-	N/A

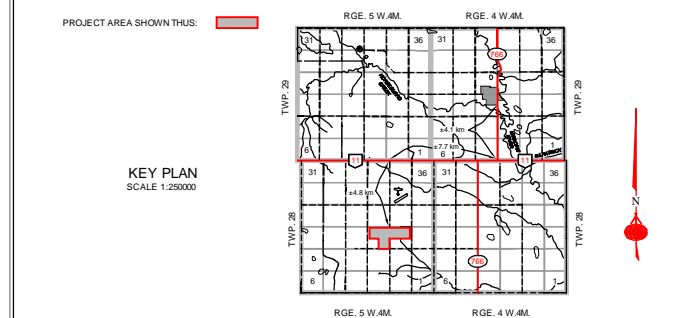

OIL COMPANY INC.

PROJECT ENGINEER

APPROVED BY

PIPE SPECIFICATIONS:

Medium to be Conveyed - Oil

Outside Diameter - 88.5mm

Wall Thickness - 4mm

Pipe Material - Steel

Pipe Grade - 359 Cat II

Max. Working Pressure - 9930 kPa

Test Pressure - 13,902 kPa

Coating Protection - YJ1

Cathodic Protection - Yes

Method of Installation - Open Trench

Depth of Cover - 1.5m

Pipe to be designed and constructed in accordance with CSA Z662-03.

LEGEND:

R/W is 15.00m in perpendicular width unless shown otherwise.

Area affected by registration of this plan is shown outlined thus

Statutory Iron Survey Posts placed are shown thus

Statutory Iron Survey Posts found are shown thus

Temporary Survey point are shown thus

Overhead Powerlines are shown thus

Buried Pipelines are shown thus

Buried Cables are shown thus

Buried Gas Co-op Pipelines are shown thus

Fences are shown thus

Distances are in metres and decimals thereof.

0 50 100 200 300 400 500 600
SCALE: 1:5000 METRES

This plan represents the best information available at the time of survey. GLOBAL SURVEYS GROUP INC. and its employees take no responsibility for the location of any underground conduits, pipes or other facilities whether shown or omitted from this plan. All underground installations should be located by the respective authorities prior to construction.

CALL ALBERTA ONE CALL : 1-800-242-3447

REV.	DESCRIPTION	DATE
0	ISSUED	2006.01.01

OIL COMPANY INC.

PLAN SHOWING
PIPELINE CONSTRUCTION ALIGNMENT
WITHIN
N. 1/2 SEC. 14
and
N. 1/2 & S.E. 1/4 SEC. 15
TWP. 28 RGE. 5 W.4M.
STARLAND COUNTY

LENGTH OF P/L R/W - FROM 10-14-28-5 W4M. TO 14-15-28-5 W4M. - 2491m

LENGTH OF P/L R/W - FROM 8-15-28-5 W4M. TO 9-15-28-5 W4M. - 118m

TOTAL LENGTH OF P/L R/W - 2609m

GLOBAL SURVEYS
#306 - 301-14 St. N.W. Calgary, Alberta T2N 2A1
Ph: 403.283.5455 Fax: 403.283.5418

REVISION

0